



Cougar AIR OPERATED BALL VIBRATORS

COUGAR



Model	In Lbs	Min. Starting Pressure (PSI)		At 20 PSI			At 40 PSI			At 60 PSI			At 80 PSI			At 100 PSI			Max Lbs in Sloped Section of Bin
		Horz.	Vert.	RPM	Force	CFM	RPM	Force	CFM	RPM	Force	CFM	RPM	Force	CFM	RPM	Force	CFM	
ABF-10	.003	12	20	9 500	8	2.8	15 000	19	4.3	15 500	20	6	19 000	31	7.5	19 200	31	9.2	310
ABF-13	.008	3	18	8 600	17	3.7	13 000	38	5.9	15 100	52	8.1	17 000	66	10	17 500	70	12.5	700
ABF-19	.037	5	20	7 750	63	4.9	11 000	127	9	13 250	184	11.1	15 500	252	14.1	16 000	269	16.5	2696
ABF-25	.116	5	41	6 400	135	5.8	8 100	216	9.4	9 700	313	12.8	11 100	406	16.3	12 000	474	19.5	4740
ABF-35	.210	5	41	7 000	292	7.1	8 200	401	10.9	10 750	689	14.7	11 500	789	18.9	12 750	970	22	9700
ABF-41	.750	5	65	3 000	192	10.4	4 000	341	16.6	5 000	533	20.8	5 500	644	29	5 800	717	34	7170
ABF-51	1.13	5	84	2 100	142	10.4	3 000	289	16.6	3 600	416	22.5	5 000	802	29	5 600	1 006	35	10 060



Model	In Lbs	Min. Starting Pressure (PSI)		At 20 PSI			At 40 PSI			At 60 PSI			At 80 PSI			At 100 PSI			Max Lbs in Sloped Section of Bin
		Horz.	Vert.	RPM	Force	CFM	RPM	Force	CFM	RPM	Force	CFM	RPM	Force	CFM	RPM	Force	CFM	
ABL-10	.003	4	5	15 750	21	3.3	21 000	37	6.4	23 000	45	6.4	24 000	49	8.4	26 000	57	10.5	570
ABL-13	.008	5	10	13 000	38	4.2	17 500	70	6.6	19 500	86	8.8	20 000	91	11.3	20 000	91	13.5	910
ABL-19	.037	5	13	8 750	80	5.2	10 500	116	8.3	15 000	236	11.2	16 000	269	16.1	17 000	303	17.5	3030
ABL-25	.116	5	19	7 400	180	6.6	10 000	329	10.4	11 000	399	14.1	12 500	515	18.1	12 750	515	23.5	5150



Model	In Lbs	Min. Starting Pressure (PSI)		At 20 PSI			At 40 PSI			At 60 PSI			At 80 PSI			At 100 PSI			Max Lbs in Sloped Section of Bin
		Horz.	Vert.	RPM	Force	CFM	RPM	Force	CFM	RPM	Force	CFM	RPM	Force	CFM	RPM	Force	CFM	
ABU-6	.001	1	1	17 000	8	2	22 000	14	3.5	25 000	18	4.5	26 000	19	6	27 000	20	8.5	200
ABU-13	.008	5	10	13 000	38	4.2	15 000	51	5	20 000	90	7.5	12 000	100	10.5	22 000	109	11.9	1 090
ABU-19	.037	5	13	10 500	116	4	14 000	205	7	16 000	270	11	17 000	303	14	18 000	340	16.5	3 400
ABU-25	.116	5	19	7 400	180	6.6	9 700	309	10	11 000	398	13	12 000	474	16	13 000	556	19	5 560
ABU-32	.240	5	30	5 100	178	6	6 500	288	11	7 500	383	17	11 500	901	19.2	12 500	1 065	23.5	10 650
ABU-38	.480	5	50	4 200	240	7	5 500	412	14	6 200	524	20	10 000	1 363	24.6	10 500	1 502	26.4	15 020
ABU-44	.915	5	60	3 200	266	9	5 100	675	15	6 000	935	21	6 500	1 097	26	7 000	1 273	29.5	12 730

AIR VIBRATORS

Cougar



RAIL CARS

AC4-3000

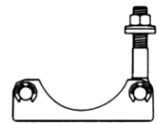

Weld-on Bracket

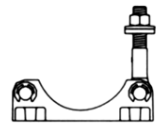

Bolt-on bracket

CLAMP ON

AL4-3500

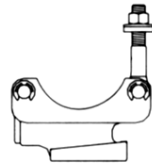

Wedge Bracket

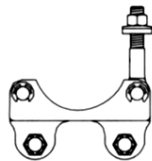

Clamp-on bracket

CRADLE MOUNT WEDGE BRACKET

AC11-5000



Model	Max RPM	1	2 *	3	4	5	6	7	Max PSI	Max CFM	dB ²
AA4-3300	4 500	1 150 (2.0)	1 350 (2.4)	1 650 (2.9)	1 950 (3.4)	2 250 (3.9)	2 550 (4.4)	3 300 (5.8)	80	50	90
AC4-3000	4 600	1 550 (2.6)	1 800 (3.0)	2 150 (3.6)	2 400 (4.0)	2 750 (4.6)	3 000 (4.6)	-	80	48.4	95
AC3-3500	3 500	1 800 (5.2)	2 100 (6.0)	2 500 (7.2)	2 800 (8.1)	3 200 (9.2)	3 500 (10.1)	-	80	50	97
AL4-3000	4 600	1 550 (2.6)	1 800 (3.0)	2 150 (3.6)	2 400 (4.0)	2 750 (4.6)	3 000 (5.0)	-	80	48.4	95
AL3-3500	3 500	1 800 (5.2)	2 100 (6.0)	2 500 (7.2)	2 800 (9.2)	3 200 (9.2)	3 500 (10.1)	-	80	50	97
AA15-2600	15 000	-	-	-	-	-	-	2 697 (.42)	80	41.3	94
AC15-2600	15 000	-	-	-	-	-	-	2 697 (.42)	80	41.3	94
AC11-5000	11 295	-	-	-	-	-	-	5 000 (1.4)	87	40	90
AC11-6500	11 295	-	-	-	-	-	-	6 500 (1.8)	80	62	110

* Standard Settings

HYDRAULIC VIBRATORS

Cougar



Model	Max RPM	1	2*	3	4	5	6	7	Max PSI	Max CFM	dB ²
H9-500	9000	-	-	-	-	-	-	5 00 (.22)	1 500	3.15	84
HA9-1600	9000	800 (.35)	1 100 (.48)	1 200 (.52)	1 400 (.61)	1 600 (.69)	-	-	1 500	3.15	88
HA4-3300	4500	1 150 (2.0)	1 350 (2.4)	1 650 (2.9)	1 950 (3.4)	2 250 (3.9)	2 550 (4.4)	3 300 (5.7)	1 500	3.15	73
HC4-3000	4600	1 550 (2.6)	1 800 (3.0)	2 150 (3.6)	2 400 (4.0)	2 400 (4.0)	3 000 (5.0)	-	1 500	6.43	76
HC3-3500	3500	1 800 (5.2)	2 100 (6.0)	2 500 (7.2)	2 800 (8.1)	2 800 (8.1)	3 500 (10.1)	-	1 500	4.89	81
HL4-3000	4600	1 550 (2.6)	1 800 (3.0)	2 150 (3.6)	2 400 (4.0)	2 400 (4.0)	3 000 (5.0)	-	1 500	6.43	76
HL3-3500	3500	1 800 (5.2)	2 100 (6.0)	2 500 (7.2)	2 800 (8.1)	2 800 (8.1)	3 500 (10.1)	-	1 500	4.89	81

* Standard Settings

COUGAR



Cougar ROTARY ELECTRIC VIBRATORS

COUGAR



- Single phase
- Three phase
- Fixed speed
- Variable speed
- Adjustable force output
- Single end
- Double end
- Continuous duty
- Intermittent duty
- 15 to 5400 centrifugal force pounds
- 50 / 60 Hz
- Most foreign voltages available
- Specs. for 500 / 575 volt units listed

Model Number	Part #	AC Voltage 3PH - 60 HZ	Amps	Centrifugal Force lb. (in. lb.)								Max Weight In Slope Section of Bin	Max RPM (VPM)	P h a s e	HP	dB	Motor Enclosure	Type of Motor	Cord Length	Vibrator Weight		
				Max																	Min	
				8	7	6	5	4	3	2	1											
D3-500	205700	230 / 460 AC	.8 / .4	475 (1.41)	436 (1.29)	417 (1.23)	354 (1.05)	243 (0.72)	185 (0.55)	100 (0.23)	37 (0.11)	10000 lb	3450	3	1/3	70	A	A	A	20 lb		
	205588	550 / 575 AC	.35 / .3	2112N	1939N	1845N	1574N	1080N	822N	444N	164N	4536 kg								9.1 kg		
D3-950	205236	230 / 460 AC	1.1 / .55	-	950 (2.8)	850 (2.5)	700 (2.5)	550 (1.6)	400 (1.2)	250 (.74)	150 (.44)	19000 lb	3450	3	1/3	59	A	A	A	45 lb		
	205243	550 / 575 AC	.46 / .44	-	4225N	3780N	3113N	2446N	1779N	1112N	667N	8618 kg								20.4 kg		
D3-1800	205208	230 / 460 AC	3.2 / 1.6	-	-	-	1800 (5.3)	1550 (4.58)	1300 (3.8)	1050 (3.1)	800 (2.4)	36000 lb	3450	3	1	71	A	A	A	79 lb		
	205212	550 / 575 AC	1.4 / 1.3	-	-	-	8006N	6894N	5782N	4670N	3558N	16329 kg								35.8 kg		
D3-3600	205296	230 / 460 AC	3.2 / 1.6	-	-	-	3600 (10.6)	3050 (9.0)	2600 (7.7)	2150 (6.4)	1700 (5.0)	72000 lb	3450	3	1	73	A	A	A	96 lb		
	205297	550 / 575 AC	1.4 / 1.3	-	-	-	16013N	13567N	11565N	9563N	7561N	32658 kg								43.5 kg		
D3-5400	205261	230 / 460 AC	8.4 / 4.2	-	-	-	5400 (16.0)	4975 (14.7)	4450 (13.16)	3925 (11.6)	3400 (10.1)	100800 lb	3450	3	3	75	A	A	A	135 lb		
	205262	550 / 575 AC	3.6 / 3.4	-	-	-	24020N	22129N	19794N	17459N	15123N	48987 kg								61.2 kg		
S3-300	205233	230 / 460 AC	1.1 / .55	-	-	-	300 (0.9)	250 (0.74)	200 (0.6)	137 (0.4)	75 (.22)	6000 lb	3450	3	1/3	57	A	A	A	33 lb		
	205234	550 / 575 AC	.46 / .44	-	-	-	1334N	1112N	889N	609N	333N	2721 kg								15.0 kg		
C3-1100	205252	230 / 460 AC	3.4 / 1.7	-	-	-	1100 (12.7)	950 (11.0)	800 (9.3)	675 (7.8)	550 (6.4)	33000 lb	1745	3	1	56	A	A	A	98 lb		
	205254	550 / 575 AC	1.5 / 1.4	-	-	-	4893N	4225N	3558N	3002N	2446N	14968 kg								44.5 kg		
C3-1400	205253	230 / 460 AC	4.6 / 2.3	-	-	-	1400 (16.2)	1275 (14.7)	1150 (13.3)	1000 (11.6)	875 (10.1)	42000 lb	1745	3	1 1/2	56	A	A	A	107 lb		
	205255	550 / 575 AC	2.0 / 1.9	-	-	-	6227N	5671N	5115N	4448N	3892N	19050 kg								48.5 kg		
D1-15	205287	115 AC	.5	-	15 (0.52)	-	-	-	-	-	-	300 lb	3200	1	1/100	40	D	C	E	3 lb		
					67N							136 kg								1.36 kg		
D1-500	205689	115 / 230 AC	3 / 1.5	475 (1.41)	436 (1.29)	417 (1.23)	354 (1.05)	243 (0.72)	185 (0.55)	100 (0.23)	37 (0.11)	10000 lb	3450	1	1/4	62	A	B	B	24 lb		
					2112N	1939N	1939N	1574N	1080N	822N	444N	164N								4536 kg	9.5 kg	
D1-950	205520	115 AC	4.3	-	950 (2.8)	850 (2.5)	700 (2.1)	550 (1.6)	400 (1.2)	250 (0.7)	150 (0.4)	19000 lb	3450	1	1/3	59	A	B	B	47 lb		
					4225N	3780N	3113N	2446N	1779N	1112N	667N	8618 kg								21.3 kg		
S1-80	205530	115 AC	2	-	-	-	-	-	80 (0.24)	60 (0.18)	30 (0.09)	1600 lb	3450	1	1/15	58	B	C	C	11.5 lb		
					-	-	-	-	355N	266N	133N	725 kg								5.2 kg		
S1-300	205521	115 AC	4.3	-	-	-	300 (0.9)	250 (.74)	200 (0.6)	137 (0.4)	75 (.22)	6000 lb	3450	1	1/3	57	A	B	B	35 lb		
					-	-	-	1334N	1112N	889N	609N	333N								2721 kg	15.9 kg	
U1-75 (12)	205040	115 AC / DC	.7	-	75 (0.33)	-	-	-	-	-	-	750 lb	9000	1	1/15	74	C	D	C	5 lb		
					-	333N	-	-	-	-	-	340 kg								2.2 kg		
U1-500 (12)	205636	115 AC / DC	3.7	-	-	-	-	-	500 (.22)	350 (.15)	150 (.07)	5000 lb	9000	1	1/4	78	A	D	D	14 lb		
					-	-	-	-	2224N	1557N	667N	2268 kg								6.4 kg		
DC2-700	205072	230 DC	1.52	-	700 (2.07)	-	-	-	-	-	-	14000 lb	3450	DC	1/3	75	A	E	A	43 lb		
					-	3113N	-	-	-	-	-	6350 kg								19.5 kg		

HIGH FREQUENCY ELECTRIC VIBRATORS **Cougar**



U1-1600

- Totally O'Ring Sealed from dirt & water
- Wedge Mount



Model	Voltage	Amps	Max. RPM	HP	Force lb (in lbs)			dB ²
					1	2 *	3	
U1-75	115	.7	9 000	1/15	75 (.03)	-	-	50
U1-500	115	3.7	9 000	1/4	150 (.07)	350 (.15)	500 (.22)	50
U1-500	230	1.9	9 000	1/4	150 (.07)	350 (.15)	500 (.22)	50
U1-1600	115	15	9 000	1/3	930 (.45)	1 330 (.58)	1 799 (.78)	58
U1-1600	230	7.5	9 000	1/3	930 (.45)	1 330 (.58)	1 799 (.78)	58

* Standard setting

COUGAR

ACCESSORIES **Cougar**

Model	A	B	C	D ⁶	E		F
					115v	230v	
U1-75				194269	196751		220300
U1-500			220522	STD	196751	196752	220300
U1-1600	223014	223015	220505	STD	196754	196755	

Nema 4 enclosure

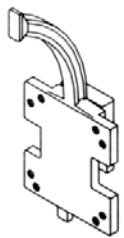

A _____
Wedge mount

D _____
Overload protection

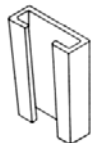

B _____
Wedge mount bracket

E _____
Speed control with overload protection

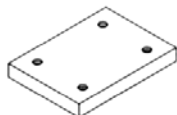

C _____
Mount plate

F _____
Safety cable

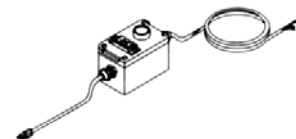
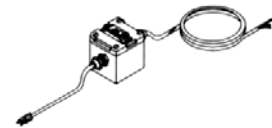



Cougar

HEAVY-DUTY ROTARY ELECTRIC VIBRATORS

COUGAR

HEAVY-DUTY ROTARY ELECTRIC VIBRATORS

- **Frequency Ranges :** 8-poles/850, 6-pole/1170 and 2-pole/3450 rpm
- **Forces Outputs From :** 100 to 44 000 lbs. centrifugal force
- Available in 70 models

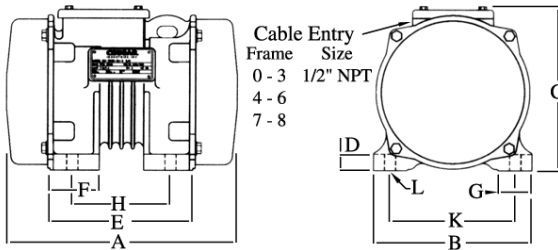

Model	HP	Force CF Lbs. (1)	Inch Lbs.	Current (2)		Dimensions										
				115 V	230 V	A	B	C	D	E	F	G	H Foot Dim.	K Bolt	L Bolt	Wt. Lbs.

1 PHASE

2 Pole 3450 RPM 60 HZ																
B1-500-1A-2	.25	500	1.48	5.0	2.5	11.6	7.7	8.3	.75	7.25	2.63	1.63	5	6	1/2	41
B1-1000-1A-2	.33	1 000	2.96	5.1	2.55	11.6	7.7	8.3	.75	7.25	2.63	1.63	5	6	1/2	43
B1-2500-2A-2	.75	2 500	7.40	12	6.0	13	8.9	9.3	1.0	8.13	2.88	2.5	5.5	7	5/8	55
4 Pole 1750 RPM 60 HZ																
B1-550-1A-4	.25	550	6.33	5.0	2.5	11.6	7.7	8.3	.75	7.25	2.63	1.63	5	6	1/2	44
B1-1000-1A-4	.33	1 000	11.5	7.5	3.75	11.6	7.7	8.3	.75	7.25	2.63	1.63	5	6	1/2	47
B1-2300-2A-4	.75	2 300	26.5	12	6.0	14.7	8.9	9.3	1.0	8.13	2.88	2.5	5.5	7	5/8	70
6 Pole 1170 RPM 60 HZ																
B1-500-2A-6	.25	500	12.9	7.50	3.75	13	8.9	9.3	1.0	8.13	2.88	2.5	5.5	7	5/8	60

3 PHASE

2 Pole 3450 RPM 60 HZ				230V	460V											
B3-500-1A-2	.25	500	1.48	1.4	.70	11.6	7.7	8.3	.75	7.25	2.63	1.63	5	6	1/2	37
B3-1000-1A-2	.33	1 000	2.96	1.4	.70	11.6	7.7	8.3	.75	7.25	2.63	1.63	5	6	1/2	39
B3-2500-2A-2	.75	2 500	7.40	2.20	1.1	13	8.9	9.3	1.0	8.13	2.88	2.5	5.5	7	5/8	54
B3-3500-2A-2	1.0	3 500	10.4	2.80	1.4	13	8.9	9.3	1.0	8.13	2.88	2.5	5.5	7	5/8	57
B3-5000-3-2	3.0	5 000	14.8	8.40	4.2	16.2	10.7	11	1.0	9.0	3.0	2.0	6	8	3/4	127
B3-6600-3-2	3.0	6 600	19.5	8.40	4.2	16.2	10.7	11	1.0	9.0	3.0	2.0	6	8	3/4	129

3 PHASE

4 Pole 1750 RPM 60 HZ																
B3-550-1A-4	.25	550	6.33	2.5	1.25	11.6	7.7	8.3	.75	7.25	2.63	1.63	5	6	1/2	40
B3-1000-1A-4	.33	1 000	11.50	2.3	1.15	11.6	7.7	8.3	.75	7.25	2.63	1.63	5	6	1/2	44
B3-2300-2A-4	.75	2 300	26.45	2.4	1.2	14.7	8.9	9.3	1.0	8.13	2.88	2.5	5.5	7	5/8	68
B3-3000-3-4	1.0	3 000	34.50	3.0	1.5	16.2	10.7	11	1.0	9.0	3.0	2.0	6	8	3/4	128
B3-4000-3-4	1.5	4 000	46.00	4.2	2.1	16.2	10.7	11	1.0	9.0	3.0	2.0	6	8	3/4	141
B1-5500-3-4	1.5	5 500	63.24	4.2	2.1	16.2	10.7	11	1.0	9.0	3.0	2.0	6	8	3/4	149

3 PHASE

6 Pole 1170 RPM 60 HZ																
B3-500-2A-6	.25	500	12.87	1.4	.70	13	8.9	9.3	1.0	8.13	2.88	2.5	5.5	7	5/8	57
B3-1000-2A-6	.50	1 000	25.73	2.6	1.3	14.7	8.9	9.3	1.0	8.13	2.88	2.5	5.5	7	5/8	66
B3-2400-3-6	.75	2 400	61.74	2.6	1.3	16.2	10.7	11	1.0	9.0	3.0	2.0	6	8	3/4	141
B3-3100-3-6	1.0	3 100	79.74	3.4	1.7	19.4	10.7	11	1.0	9.0	3.0	2.0	6	8	3/4	170

3 PHASE

8 Pole 850 RPM 60 HZ																
B3-550-2A-8	.5	550	26.81	3.2	1.6	14.7	8.9	9.3	1.0	8.13	2.88	2.5	5.5	7	5/8	73
B3-900-2A-8	.5	900	43.87	3.2	1.6	16.8	8.9	9.3	1.0	8.13	2.88	2.5	5.5	7	5/8	86
B3-1650-3-8	.75	1 650	80.42	3.8	1.9	19.4	10.7	11	1.0	9.0	3.0	2.0	6	8	3/4	169

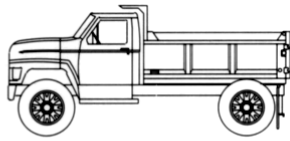

DC-1000 • DC-1600

8 to 9 foot bodies
2 to 5 yard capacity

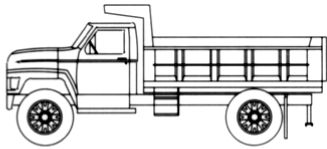

DC-1600 • DC-2500

9 to 10 foot bodies
5 to 10 yard capacity

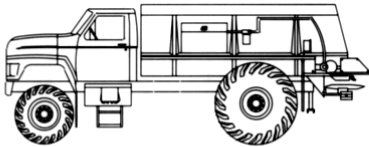

DC-2700 • DC-3200

10 to 15 foot bodies
8 to 16 yard capacity

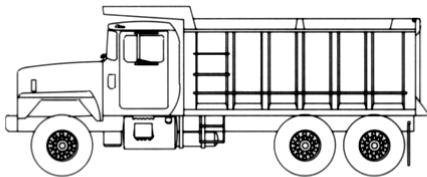

DC-1600 • DC-2500

Spreader bodies
10 to 15 foot
7 to 10 yards

DC-3200

15 to 20 foot bodies
15 to 30 yard capacity
Tandems, live bottoms and multi-axles to 40 feet

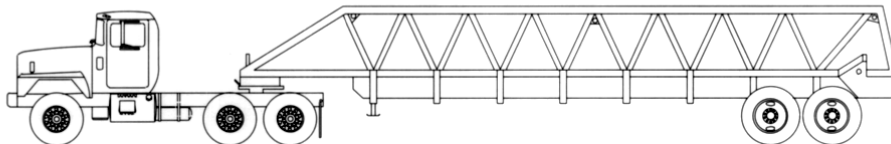

DC1-400 • DC-1000

Concrete pumps
Bins, hoppers and chutes.

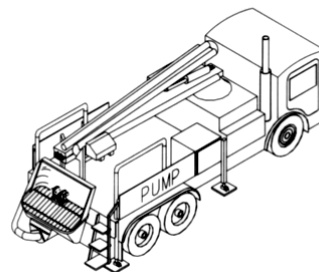
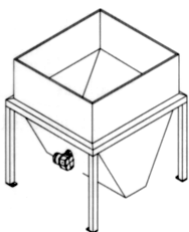



Cougar

TRUCK VIBRATORS

12 Volt				
Model	Amps	Max. RPM	Force Lbs.	Offset Wt.
DC-1000	22	5 000	1 000	1.4 in lb
DC-1600	70	5 000	1 600	2.3 in lb
DC-2500	72	5 000	2 500	3.5 in lb
DC-2700	75	4 500	2 700	4.7 in lb
DC-3200	85	4 000	3 200	7.0 in lb
DC1-400	15	3 800	410	1.0 in lb

24 Volt				
Model	Amps	Max. RPM	Force Lbs.	Offset Wt.
DC-1000	11	5 000	1 000	1.4 in lb
DC-1600	55	5 000	1 600	2.3 in lb
DC-2500	55	5 000	2 500	3.5 in lb
DC-2700	55	4 500	2 700	4.7 in lb
DC-3200	62	4 000	3 200	7.0 in lb
DC1-400	7.5	3 800	410	1.0 in lb

DC-1000 • DC-1600 • DC-2500 • DC-2700

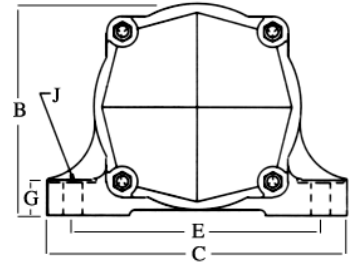
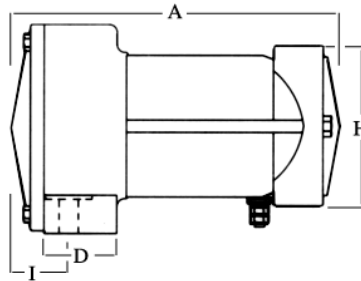

DC-3200

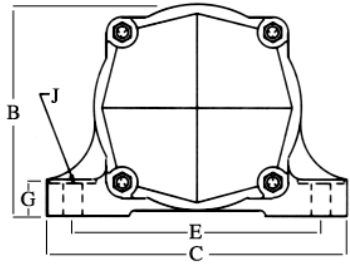
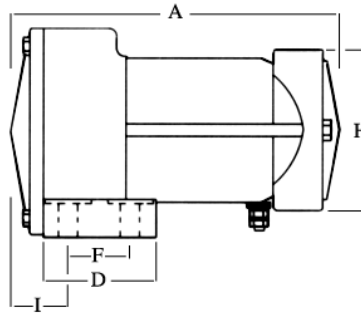

DC1-400

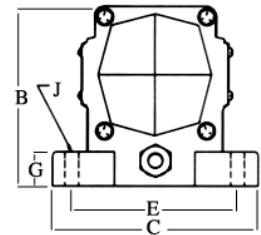
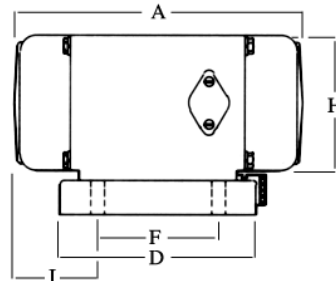

Model	Bolt Pattern									Bolt Size	Bolt Qty	Weight/lb.
	A	B	C	D	E	F	G	H	I			
DC-1000	9"	6 1/2"	9 3/4"	2 1/4"	8"		1"	3 7/8"	2 1/4"	1/2" x 1 1/2"	2	23
DC-1600	10"	6 7/8"	9 3/4"	2 1/4"	8"		1 3/16"	5 1/4"	1 3/4"	5/8" x 1 3/4"	2	30
DC-2500	10"	6 7/8"	9 3/4"	2 1/4"	8"		1 3/16"	5 1/4"	1 3/4"	5/8" x 1 3/4"	2	31
DC-2700	10"	6 7/8"	9 3/4"	2 1/4"	8"		1 3/16"	5 1/4"	1 3/4"	5/8" x 1 3/4"	2	32
DC-3200	10 3/8"	6 7/8"	9 3/4"	3 5/8"	8"	2"	1 3/16"	5 1/4"	2"	5/8" x 1 3/4"	4	36
DC1-400	9 1/16"	5 9/16"	6 3/8"	6 1/4"	5"	3 3/4"	1 1/8"	4 1/4"	2 3/4"	3/8" x 1 1/2"	4	18

COUGAR



INSTALLATION KITS

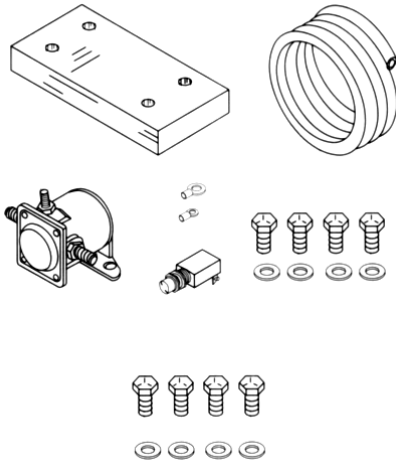

Installation kits for DC-1000, DC-1600, DC-2500, DC-2700, DC-3200; Are shipped with each of these units. Each kit includes: 25' cable, mounting plate, bolts, washers, switch, solenoid and terminals.

Installation kit for DC1-400;
Each unit includes mounting bolts and washers.

TYPICAL INSTALLATION

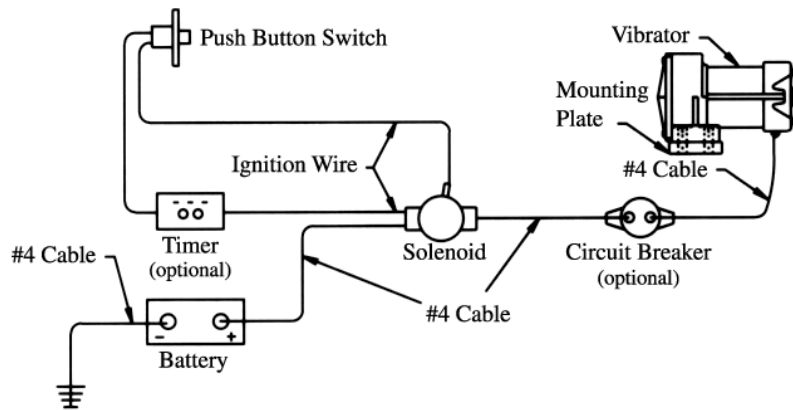

METALLIC IMPACT VIBRATOR Cleveland



Model VMS

SIZING CHART FOR BINS AND HOPPERS		
BIN CAPACITY	APPROXIMATE SKIN THICKNESS OF BIN (INCHES)	VMS VIBRATOR SIZE
700 lbs	1/8	1125
1 ton	1/8 to 3/16	1150
3 ton	3/16 to 1/4	1200
20 ton	5/16 to 3/8	1300
50 ton	3/8	1350
100 ton	3/8 to 1/2	1400
100 ton & UP	3/4 to 1	1500



Model	PSTN. Dia.	A	B	C	D	E	F	Weight Lbs	Air CNSMP (scfm) @ 60 PSIG	Frequency (Vibration per Minute) @ 60 PSIG
1125	1 1/4	4 11/18	3	3	2	3/8	1/4	6	7.2	4640
1150	1 1/2	5 13/16	4 1/8	4 1/8	3	5/8	1/4	13	7.4	4000
1200	2	6 9/16	4 3/8	4 3/8	3	5/8	1/4	14	7.2	4500
1300	3	8 7/16	5 3/4	5 3/4	4 1/8	3/4	3/8	28	18.5	3350
1350	3 1/2	10 9/16	5 3/4	5 3/4	4 1/8	3/4	1/2	34	17.5	2400
1400	4	12	8 1/2	8 1/2	6 1/4	1 1/4	1/2	99	25.0	2100
1500	5	17	11	11	7 7/16	1 1/2	3/4	235	33.0	1150

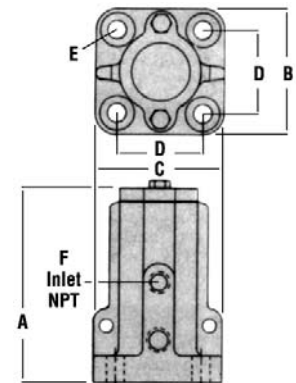

METALLIC IMPACT VIBRATOR Cleveland

Model SA-EP

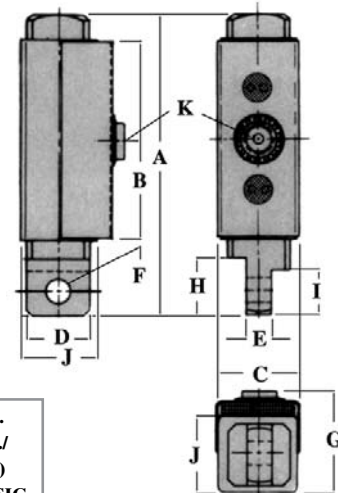
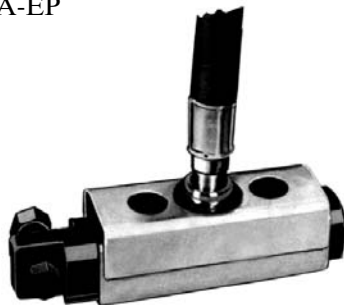

PSTN. Dia.	A	B	D	Bolt Size F	G	H	I	J	K	NPT	Weight lbs	Air CNSMP (scfm) @ 60 PSIG	Freq. (vibs./Min.) @ 60 PSIG
U1-75	5 3/16	3 3/4	3/4	5/16	1 13/32	13/16	9/16	7/8	1/8	1	1	3.8	16000
U1-500	5 3/8	3 3/4	7/8	3/8	1 17/32	1	3/4	1	1/4	1 1/4	1 1/4	4.0	14100
U1-500	5 3/8	3 3/4	1	3/8	1 23/32	1	3/4	1 3/16	1/4	1 3/4	1 3/4	5.6	12700
U1-1600	5 15/16	3 15/16	1 1/4	1/2	2 1/32	1 3/16	15/16	1 1/2	1/4	3 1/2	3 1/2	5.8	11000
U1-1600	7 5/8	5 3/8	1 5/8	1/2	2 3/4	1 7/16	1 7/16	2 3/16	1/4	6 3/4	6 3/4	6.0	7600

CLEVELAND