

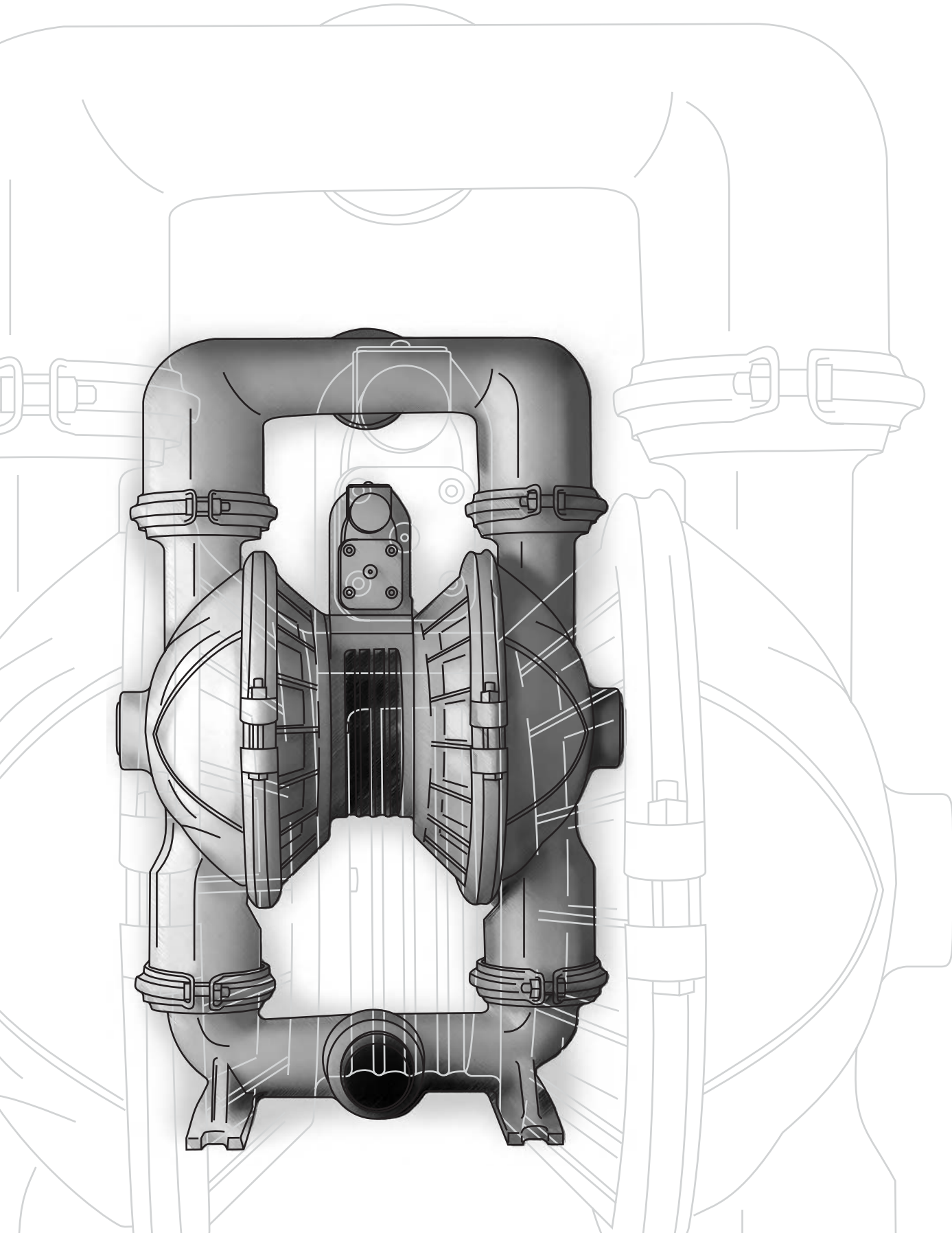

**POMPE À DIAPHRAGME**  
**DIAPHRAGM PUMP**



**ASYBCO**



### Features

- Heavy-duty industrial construction
- Hydraulically balanced diaphragms
- Positive displacement
- No troublesome cups, packings, or seals
- Quiet, smooth operation
- Runs dry without damage
- Self-priming
- Many materials of construction

MODELS : D - 10 • D - 10/8 • D - 10/6 • D - 10/4

MODEL : D - 25 • H - 25



### Applications

### D 10

- Hot fluids water
- Slurries
- Wettable powders
- Chemicals
- Soap solutions
- Reclaim
- Abrasives
- Fertilizers
- Adhesives
- Salt water

### Applications

### D 25 & H-25

- Hot fluids water
- Slurries
- Wettable powders
- Chemicals
- Soap solutions
- Reclaim
- Abrasives
- Fertilizers
- Adhesives
- Salt water

Specifications		
Model	Capacity	Liters / Min.
D - 10	1 - 8.5 gpm	3.8 - 30.3
D - 10/8	1 - 8 gpm	3.8 - 30.3
D - 10/6	1 - 6 gpm	3.8 - 22.7
D - 10/4	1 - 4 gpm	3.8 - 15.1
<b>Max Inlet Pressure :</b>	200 psi	14 bar
<b>Pressure :</b>	1 000 psi	69 bar
<b>Max Temperature :</b>	250°F	consult factory in excess of 180°F
<b>Inlet Port :</b>	1 npt	
<b>Discharge Port :</b>	3/4 npt	
<b>Shaft Diameter :</b>	7/8"	
<b>Shaft Rotation :</b>	Reversible	
<b>Dimensions :</b>	<b>Inches</b>	<b>MM</b>
Length :	10.75	273
Width :	7.25	184
Height :	7.89	200
<b>Bearings :</b>	Timken tapered roller	
<b>Reservoir Capacity :</b>	1 U.S. quart	0.95 liters
<b>Weight Pump :</b>	40 - 45 lbs	18.1 - 20.4 kg

Specifications		
<b>Capacity :</b>	1 - 20 gpm	3.8 - 75.7 liters / min.
<b>Max Inlet Pressure :</b>	25 psi	1.7 bar
<b>Pressure :</b>	1 000 psi	69 bar
<b>Max Temperature :</b>	250°F	consult factory in excess of 160°F
<b>Inlet Port :</b>	1 1/2 npt	
<b>Discharge Port :</b>	1 npt	
<b>Shaft Diameter</b>	<b>Inches</b>	
<b>D-25 :</b>	1	
<b>H - 25 :</b>	1 1/8	
<b>Shaft Rotation :</b>	Reversible	
<b>Dimensions</b>	<b>Inches</b>	<b>MM</b>
Length :	16.2	411
Width :	9.45	240
Height :	10.35	263
<b>Bearings :</b>	Timken tapered roller	
<b>Reservoir Capacity :</b>	5 U.S. pints	2.4 liters
<b>Weight Pump :</b>	110 - 120 lbs	50-54 kg

HYDRA-CELL



# Hydra-Cell DIAPHRAGM PUMP

HYDRA-CELL

## Features

- Heavy-duty industrial construction
- Hydraulically balanced diaphragms
- Positive displacement
- No troublesome cups, packings, or seals
- Quiet, smooth operation
- Runs dry without damage
- Self-priming
- Many materials of construction

MODEL : D - 35

MODELS : M - 03 • M - 13 • M - 23 • D - 03

## Applications

- Hot fluids
- Machine coolant
- Slurries
- Wettable powders
- Fertilizers
- Soap solutions
- Chemicals
- Reclaim water
- Abrasives
- Cutting fluids
- Adhesives
- Salt water



## Applications

- Hot fluids
- Slurries
- Wettable powders
- Chemicals
- Soap solutions
- Reclaim water
- Abrasives
- Fertilizers
- Adhesives
- Salt water



Specifications		
Capacity :	4 - 37 gpm	16 - 140 liters / min.
Pressure :	1200 psi	83 bar
Max Temperature :	250°F	consult factory in excess of 140°F
Inlet Port :	2 1/2 npt or SAE flange	
Discharge Port :	1 1/4 npt or SAE flange	
Shaft Diameter :	2"	
Shaft Rotation :	Reversible	
Bearings :	Timken tapered roller bearings	
Reservoir Capacity :	5 U.S. quarts	4.75 liters
Weight Pump :	240 lbs	109 kg

Specifications			
<b>Model</b>			
M - 03	Direct drive (close-coupled), 56C		
M - 13	Direct drive (Close-coupled), metric, 90L		
M - 23	Direct drive (close-coupled), Honda engine, 2:1 gearbox		
D - 03	Shaft drive		
<b>Capacity</b>	<b>GPM</b>	<b>Liters/Min</b>	
D - 03/2.2	0.25 - 2.2	0.95 - 8.3	
D - 03 / 3.0	0.25 - 3.0	0.95 - 11.4	
<b>Pressure</b>	<b>PSI @ GPM</b>	<b>Bar @ Liters/Min</b>	
	1000 @ 3.0	69 @ 11.4	
	1200 @ 2.2	83 @ 8.3	
<b>Max Temperature</b>	250°F	Consult factory in excess of 160°F	
<b>Inlet Port</b>	1/2 npt		
<b>Discharge Port</b>	3/8 npt		
<b>Shaft Rotation</b>	Reversible		
<b>Shaft Diameter</b>	<b>Inches</b>		
D - 03	7/8		
M - 03	5/8		
<b>Dimensions</b>		<b>Inches</b>	<b>MM</b>
M - 03	Length	7.5	190
	Width	10.2	259
	Height	6.5	165
D - 03	Length	9.9	251
	Width	10.2	259
	Height	7.5	190
<b>Bearings</b>	Ball bearings		
<b>Reservoir Capacity</b>	1 U.S. quart	0.95 liters	
<b>Weight Pump</b>	28 lbs	12 kg	

# DIAPHRAGM PUMP

# Hydra-Cell

Model : M - 10/4 • M - 10/6 • M - 10/8



### Applications

- Hot fluids
- Slurries
- Wetttable powders
- Chemicals
- Soap solutions
- Reclaim water
- Abrasives
- Fertilizers
- Adhesives
- Salt water

### Features

- Heavy-duty industrial construction
- Quiet, smooth operation
- Hydraulically balanced diaphragms
- Runs dry without damage
- Positive displacement
- Self-priming
- No troublesome cups, packings, or seals
- Many materials of construction

Specifications		
Model	Capacity	Liters / Min.
M - 10/8	1 - 8 gpm	3.8 - 30.3
M - 10/6	1 - 6 gpm	3.8 - 22.7
M - 10/4	1 - 4 gpm	3.8 - 15.1
<b>Max Inlet Pressure</b>	200 psi	14 bar
<b>Pressure</b>	1000 psi	69 bar
<b>Max Temperature</b>	250°F	consult factory in excess of 180°F
<b>Inlet Port</b>	1 npt	
<b>Discharge Port</b>	3/4 npt	
<b>Shaft Diameter</b>	7/8"	
<b>Shaft Rotation</b>	Reversible	
Dimensions		
	Inches	MM
Length	10.75	273
Width	7.25	184
Height	7.89	200
<b>Bearings</b>	Timken tapered roller	
<b>Reservoir Capacity</b>	1 U.S. quart	0.95 liters
<b>Weight pump</b>	40 - 45 lbs	18.1 - 20.4 kg

HYDRA-CELL



**Construction**

- PI 50 DL 304 SS Wetted Parts
- PI 50SL 316 SS Wetted Parts

**Suction and Discharge**

- Tri-clamp sanitary connection standard, other connection types optional.
- Sizes: 2" x 2" 3" x 2" 3" x 3" 4" x 4" 6" x 6"
- Ball check valves or flap check valves.

**Advantages of the PI 50 DL**

- Self priming up to 24 feet.
- Run dry without damage.



Versa-Matic **AIR-OPERATED DOUBLE DIAPHRAGM PUMPS**



**Model V1.OF**

Flows to 35 gpm - 130 lpm

	Inches	Meters
<b>Height</b>	14.5"	37.2 cm
<b>Depth</b>	8"	20.5 cm
<b>Width</b>	12"	30.8 cm
<b>Air Inlet Connect</b>	0.25"	6.25 mm
<b>Inlet</b>	1"	25 mm
<b>Discharge</b>	1"	25 mm
<b>Suction Lift</b>	15'D/25"W	4.6 m
<b>Solids Handling</b>	1/8"	3.17 mm
<b>Weight</b>	Aluminium	25 lbs.
	Iron or SS	36 lbs.

**Model DRV 1.25F & DRV 1.25S**

Flows to 70 gpm - 265 lpm

	Inches	Meters
<b>Height</b>	18"	45.7 cm
<b>Depth</b>	11 1/2"	29.2 cm
<b>Width</b>	14 1/2"	36.8 cm
<b>Air Inlet Connect</b>	3/8" NPT	9.5 mm
<b>Inlet</b>	1 1/2" NPT F	38.1 mm
<b>Discharge</b>	1 1/4" NPT M	31.75 mm
<b>Suction Lift</b>	20'D/25"W	6.1 m
<b>Solids Handling</b>	3/16" Dia	4.25 mm
<b>Weight</b>	<b>Max</b>	
	Aluminium	38 lbs.
	Iron or SS	55 lbs
	(ft. mount. only)	25 kg

**Model V2.OF & V2.OS**

Flows to 135 gpm - 511 lpm

	Inches	Meters
<b>Height</b>	26 1/2"	67.3cm
<b>Depth</b>	13"	33 cm
<b>Width</b>	16 1/8"	41 cm
<b>Air Inlet Connect</b>	1/2" NPT	12.5 mm
<b>Inlet</b>	2" NPT M	50 mm
<b>Discharge</b>	2" NPT M	50 mm
<b>Suction Lift</b>	20'D/25"W	6.1 m
<b>Solids Handling</b>	1/4" Dia.	6.35 mm
<b>Weight</b>	<b>Max</b>	
	Alu	70 lbs.
	Iron or SS	
	(ft. mount. only)	120 lbs
	Hastelloy	
(ft. mount. only)	130 lbs.	

**Model V3.OF & V3.OS**

Flows to 220 gpm - 833 lpm

	Inches	Meters
<b>Height</b>	33 3/4"	85.7 cm
<b>Depth</b>	16 1/2"	42 cm
<b>Width</b>	20"	50.8 cm
<b>Air Inlet Connect</b>	1/2" NPT	12.5 mm
<b>Inlet</b>	3" NPT M	75 mm
<b>Discharge</b>	3" NPT M	75 mm
<b>Suction Lift</b>	20'D/25"W	6.1 m
<b>Solids Handling</b>	3/8" Dia.	9.5 mm
<b>Weight</b>	<b>Max</b>	
	Aluminium	120 lbs.
	Iron or SS	
	(ft. mount. only)	215 lbs
	Hastelloy	
(ft. mount. only)	225 lbs.	

VERS-A-MATIC MURZAN

# MANUALLY OPERATED PUMPS Edson



# EDSON



- Compact
- Lever Action Pump
- 18 GPM

- Compact
- Flush wall mount pump
- 18 GPM



Performance		
<b>Max volume</b>	18 gpm	68.1 lpm at 46 strokes/min
<b>Static suction head</b>	18 ft.	5.48 m
<b>Dry suction (actual height)</b>	15 ft	4.57 m
<b>Static discharge head</b>	18 ft	5.48 m
Connections		
<b>Inlet</b>	1 1/4" or 1 1/2" male npt	
<b>Discharge</b>	1 1/4" or 1 1/2" female npt	

- Compact
- Vertical mount pump
- 18 GPM

- Compact
- Offset drive pump
- 18 GPM



- Bone dry
- Lever-Action
- Side inlet action
- 30 GPM

- Bone dry
- Lever -action
- Bottom inlet pump
- 30 GPM



Performance		
<b>Max volume</b>	30 gpm	113.6 lpm at 30 strokes/min
<b>Static suction head</b>	15 ft.	4.57 m
<b>Dry suction (actual height)</b>	12 ft	3.65 m
<b>Static discharge head</b>	15 ft	4.57 m
Connections		
<b>Model 117 &amp; 557 Inlet</b>	1 1/2" or 2" male npt	
<b>Model 554 &amp; 638 Inlet</b>	1 1/2" or 2" Female npt	
<b>Discharge</b>	1 1/2" or 2" Female npt	



- Bone dry
- Offset dry
- Side inlet pump
- 30 GPM

- Bone dry
- Offset drive
- Bottom inlet
- 30 GPM





# Edson ELECTRIC POWERED PUMPS

EDSON



- Compact
- Electric skid mount pump

Performance		
<b>Max volume</b>	18 gpm	68.1 lpm at 60 cycles/min
	7 gpm	26.5 lpm at 30 cycles/min
<b>Static suction head</b>	18 ft.	5.48 m
<b>Dry suction (actual height)</b>	15 ft	4.57 m
<b>Static discharge head</b>	18 ft	5.48 m
Continuous duty discharge height should not exceed 10 ft		
Connections		
<b>Inlet</b>	1 1/4" or 1 1/2" male npt	
<b>Discharge</b>	1 1/4" or 1 1/2" Female npt	



- Bone dry
- Electric skid mount pump

Performance		
<b>Max volume</b>	38 gpm	143.8 lpm at 60 cycles/min
	20 gpm	75.5 lpm at 30 cycles/min
<b>Static suction head</b>	15 ft.	4.57 m
<b>Dry suction (actual height)</b>	12 ft	3.65 m
<b>Static discharge head</b>	15 ft	4.57 m
Continuous duty discharge height should not exceed 10 ft		
Connections		
<b>Inlet</b>	1 1/2" or 2" male npt	
<b>Discharge</b>	1 1/2" or 2" Female npt	



- Heavy duty
- Electric skid mount pump

- Heavy duty
- Electric trailer mount pump

Performance		
<b>Max volume</b>	130 gpm	492 lpm at 60 cycles/min
<b>Static suction head</b>	25 ft.	7.62 m
<b>Dry suction (actual height)</b>	20 ft	6.1 m
<b>Static discharge head</b>	25 ft	7.62 m
Continuous duty discharge height should not exceed 10 ft		
Connections		
<b>Inlet</b>	3" or 4" male npt	
<b>Discharge</b>	3" or 4" Female npt	